

## Sign In Screen

To access the Orchid Core VMS user interface, open a web browser on your PC or mobile device.

**To sign in:** In the web browser address bar, type the Orchid Core VMS server IP address. Type `localhost` if you are working on the Orchid Core VMS server itself.



When the *Sign In* screen appears, enter a valid username and password.

## User Interface

Live video, recorded video playback, and video exporting are all available from the *Stage*, where *Players* can be moved, resized, and replaced as needed. Additional features are accessible via the *System Menu*.

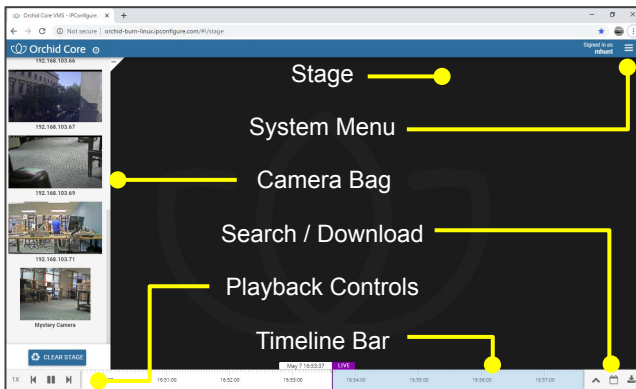

## The Camera Bag

The *Camera Bag* lists all of the cameras that have been registered to the system, in alphabetical order by camera name, with thumbnail images for each. When the *Camera Bag* is open, you may add cameras to the *Stage* (as *Players*) for live video viewing, recorded video playback, and search.

**To open/close the *Camera Bag*:** To open, click on the (+) icon in the top-left corner of the *Stage*. To close, click on the (-) icon.

## Playing Video

**To add a *Player* to the *Stage*:** Double-click on a camera thumbnail in the *Camera Bag*, or click and drag a thumbnail from the *Camera Bag* to the *Stage*.

**To remove a *Player* from the *Stage*:** Click on the "X" in the top-right corner of the *Player*.

**To remove all *Players* from the *Stage*:** Click the **Clear Stage** button at the bottom of the *Camera Bag*.

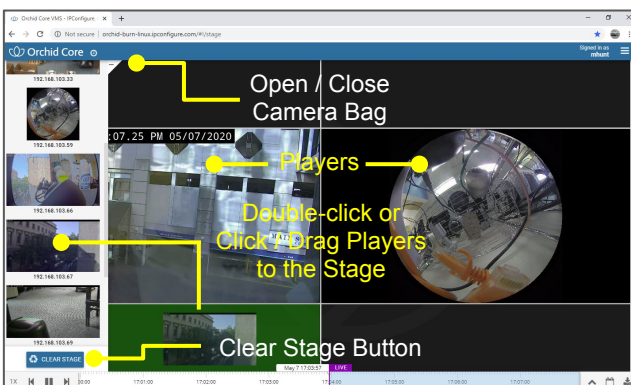

## The Player

Hover the cursor over the *Player* to activate the tools pictured below.

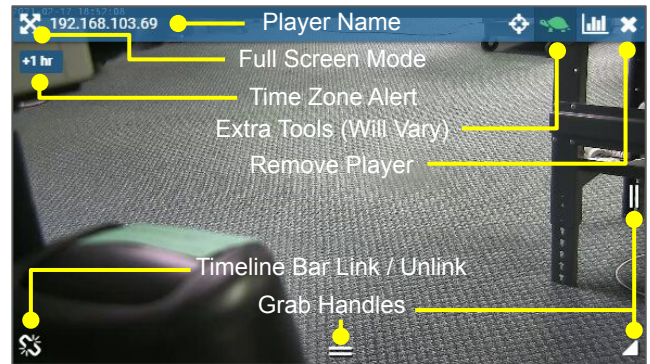

**Note:** The **Time Zone Alert** icon will only appear if the server and client are in different time zones.

**To increase a *Player* to full-screen:** Click on the **Full-screen** icon to maximize a *Player* to full-screen size. Click the icon again to return the *Player* to its original size and position among other *Players* on the *Stage*.

**To perform an in-cell search:** Click on the **Un-Link** icon to activate an in-cell search. The *Player* is unlinked from the main *Timeline Bar* so a video search can be performed using an independent timeline. Click the icon again (now the **Link** icon) to reconnect to the main *Timeline Bar*.

**To resize a *Player*:** Click and drag the grab handles to resize a *Player*. (Keep in mind that you can't move or resize a *Player* on top of another *Player*; you may need to reposition some of the *Players* first.)

## Camera Pan-Tilt-Zoom (PTZ) (If Available)

If you have cameras with PTZ capabilities, you can control these features through the *Player*.

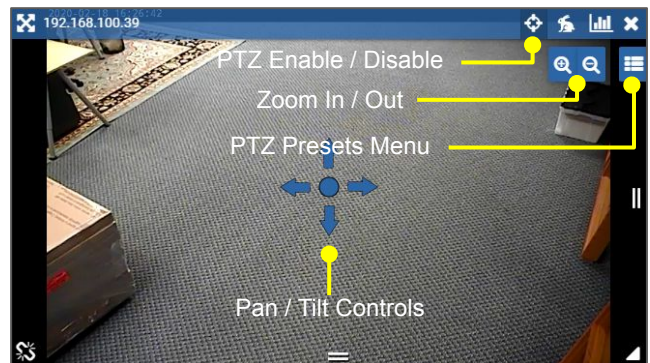

**To control PTZ:** Enable PTZ control by clicking on the **PTZ** icon. Then use the Pan/Tilt controls and the Zoom controls that appear on-screen. (Control is available using a mouse, joystick, or touch supported inputs.) Use the *Presets Menu* to switch between predefined camera views.

**Note:** The **PTZ** icon will only appear on cameras that are PTZ-capable.

## Fisheye Camera Dewarping (If Available)

Click the **Dewarping** icon to activate the Dewarping toolbar, allowing you to select the standard fisheye or one of two "flattened" camera views.

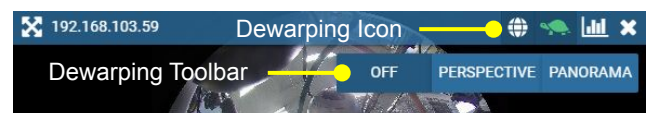

## The Timeline Bar - Viewing Live and Recorded Video

The *Timeline Bar* at the bottom of the *Stage* includes all of the tools you need for live video viewing and recorded video playback. In Live mode (indicated by the purple **LIVE** icon), Orchid Core VMS plays real-time video on all of the linked Players on the *Stage*. The Play Line will always pinpoint the date and time of the video currently playing on all of the linked Players.

### To navigate through time, do any of the following:

- Click and drag the timeline (to the right or left).
- Click once on the timeline to center a specific point in time on the Play Line.
- Use the **Jump To** icons to move to the previous or next motion event.
- Use the **Calendar Picker** icon to select a specific date/time. (The green dots indicate the days on which video is available.)
- Click the **LIVE** icon to return to Live mode.

### To control video for the linked Players on the Stage:

- Click the **Play/Pause** icon to play or pause video.
- Click the **1X** icon to access controls that allow you to adjust playback speed and direction (faster and slower, forward and reverse).

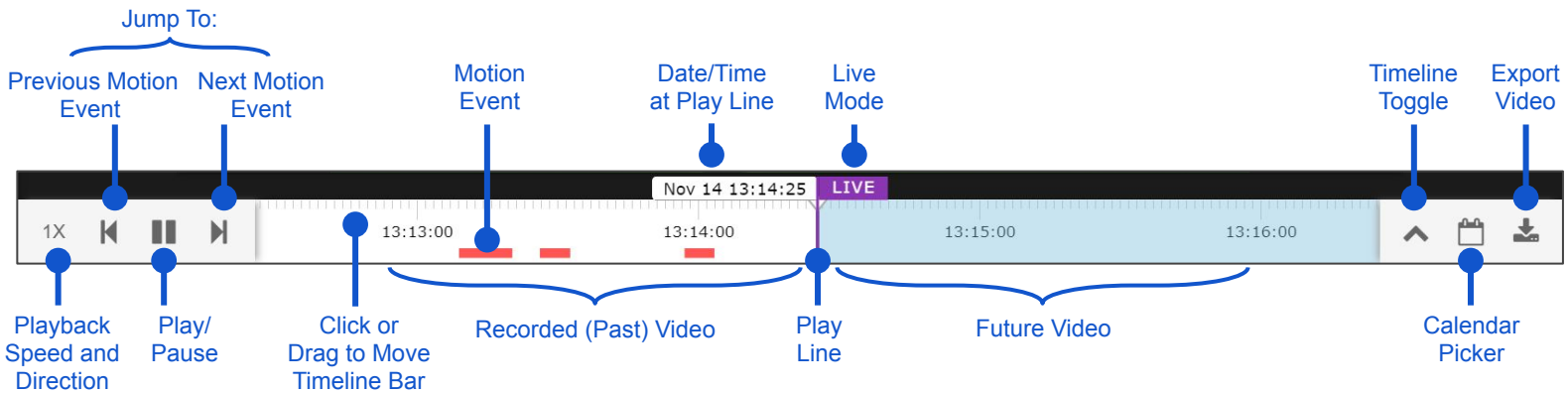

## The Timeline Bar - Searching and Exporting Video (for Players on the Stage)

The *Timeline Bar* has tools that will allow you to export video quickly (for a known date/time), or search for the video you need to export.

### To export video for a known date and time:

- Click the **Export** icon. (An Export window will open at which you will select the date/time range and a specific camera stream.)
- Use the two calendar buttons to select the *Start Date/Time* and the *End Date/Time*.
- Select video for export by identifying the Player (via the thumbnail), then click one of the video format buttons (MKV, MOV, Dewarp) for that Player.

### To select video for review/export:

- Click the **Timeline Toggle** icon to activate Search mode. In Search mode, the *Timeline Bar* expands to provide additional tools for identifying specific portions of video (generally for detailed review and/or export).
- Use the **Calendar Picker** icon and/or the Coarse Adjustment Handles (click and drag) to select a Coarse Search Area. (The area between the handles represents the narrowed search area which is then reflected in the Fine Search Area.)
- You may use the Range Selector to choose the time increments for the Coarse Timeline (from 5 minutes to 12 hours).
- Click and drag the Fine Adjustment Handles to further narrow the search area and finalize the video selection for review/export. (This selection of video will play in a loop until you change the search area or exit selection mode.)

### To export selected video:

- Click the **Export** icon to download video from the selected period. Select the video format (MKV, MOV, Dewarp) for the clip you want to download.
- After the download is complete, you may select another clip (from the same time period) for download.

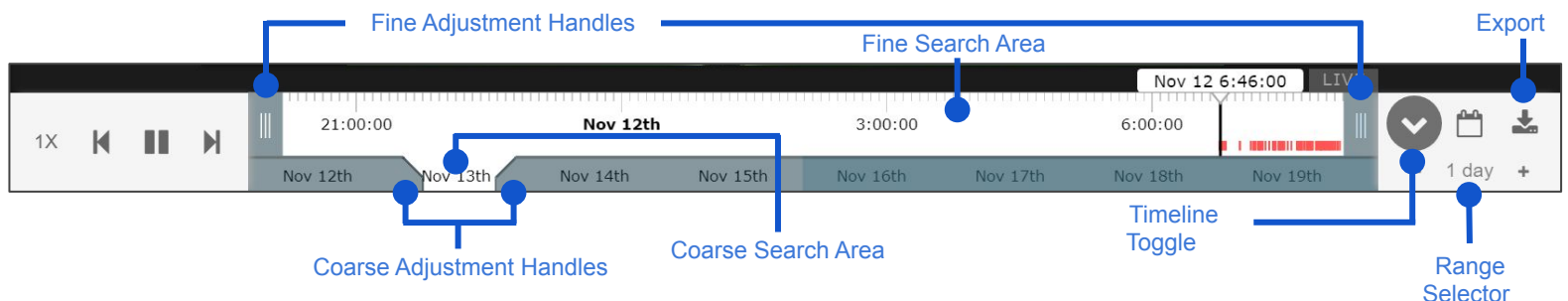

For additional tips and training, complete the Orchid Core VMS training available at: [training.ipconfigure.com](http://training.ipconfigure.com).